

Create a Custom DEC Login



Released 1.1

27 January 2020

Digital Engineering Cloud®

dec-support@sabelsystems.com

(866) 518-5335

Prepared by:



2290 Lakeview Dr., Suite D

Beavercreek, Ohio 45431

Document Revision History

Version	Date	Edited by	Summary of Change
1.0	31 October 2019	Curtis Adams	Initial Draft
1.1	27 January 2020	Curtis Adams	Updated screens to match HmC changes.

Table of Contents

1. Creating a Custom Login to a Remote Desktop.....2

1. Creating a Custom Login to a Remote Desktop

You can save yourself a little time logging in to the remote desktop of your DEC project by creating a custom login. This process will pass your username to the remote desktop eliminating the need to always enter the domain and your username each time you are logging on the remote desktop. Once completed the option will remain until deleted by you. You do however need to do this once for each server you connect with.

1.1. Connect and sign in to HmC. (See your project's Remote Desktop Access Instructions for details.)

1.2. Select the remote computer you wish to connect with and select the **Connect** button. (See your project's Remote Desktop Access Instructions for details.)

1.3. A "Connect to" window will be displayed.

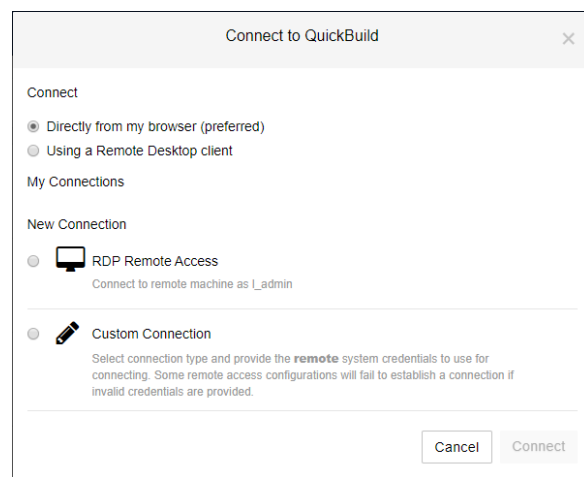

1.4. Select **Custom Connection**.

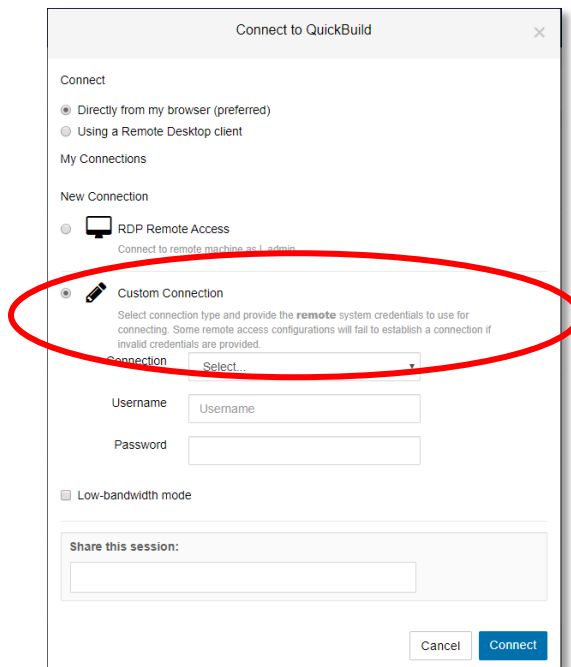

1.5. Under the Connection field drop-down menu, choose **RDP Remote Access**.

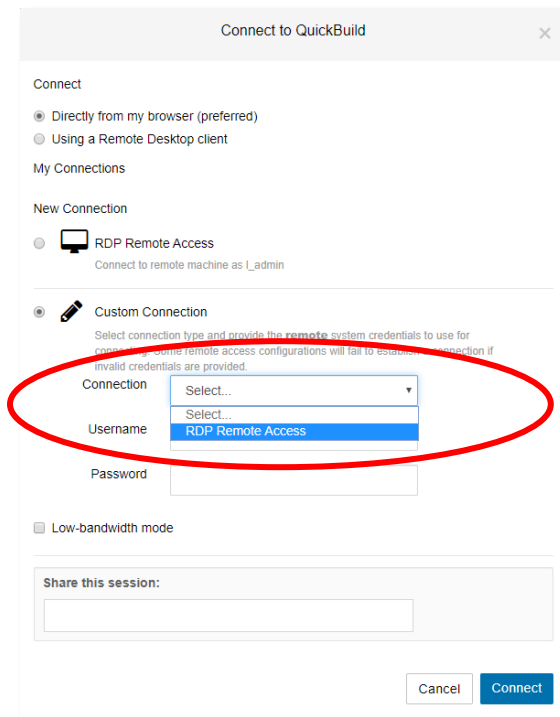

1.6. In the Username field, enter the DEC domain and your DEC username separated by a back-slash (sabhmc\firstname.lastname).

1.7. Enter your DEC network password in the Password field and click the **Connect** button.

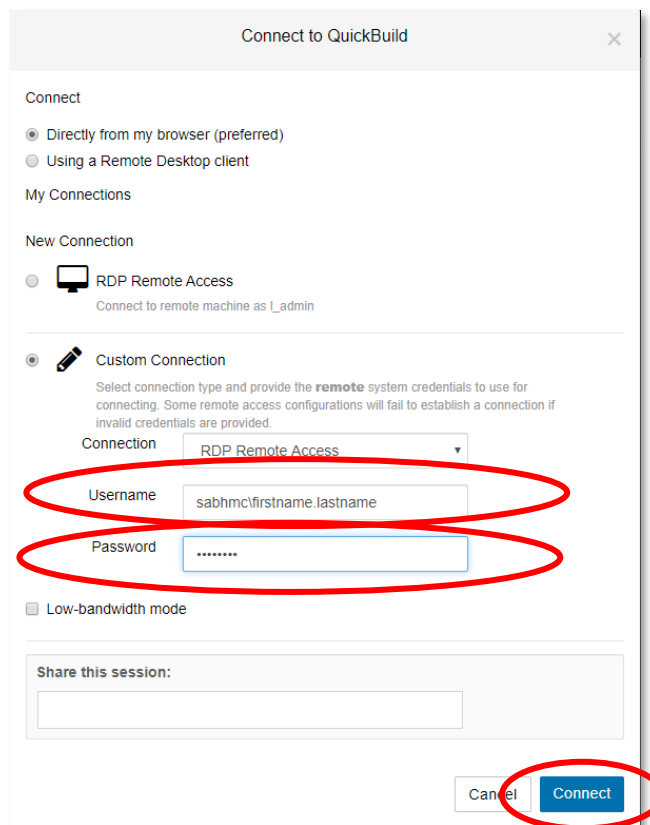

- 1.8. Login to the selected remote desktop as you normally would.
- 1.9. The remote desktop username field will be filled with the username you entered in the Connect To window. However, your password will never be transferred because of security.

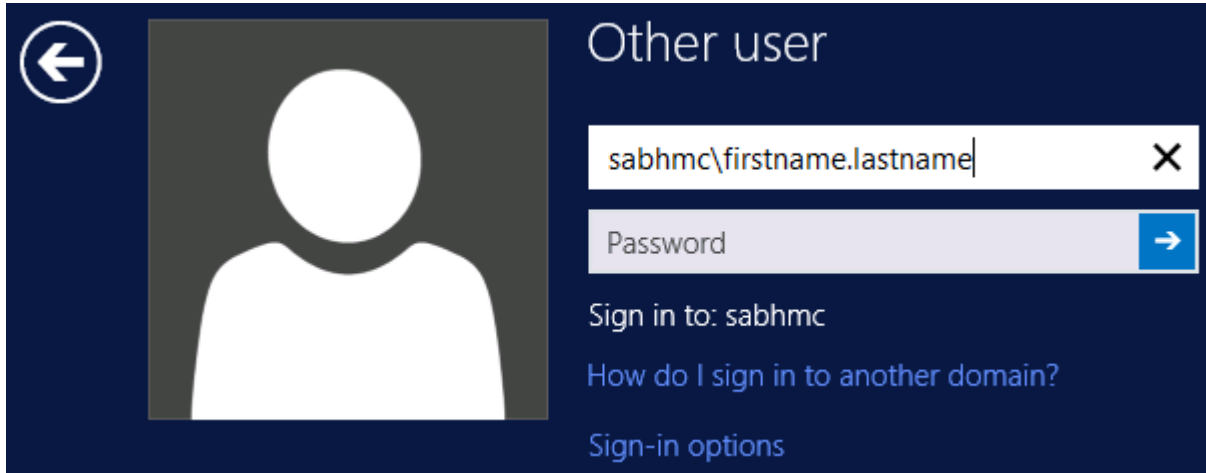

- 1.10. The next time you access that computer, you will see an entry in My Connections containing your DEC network username.

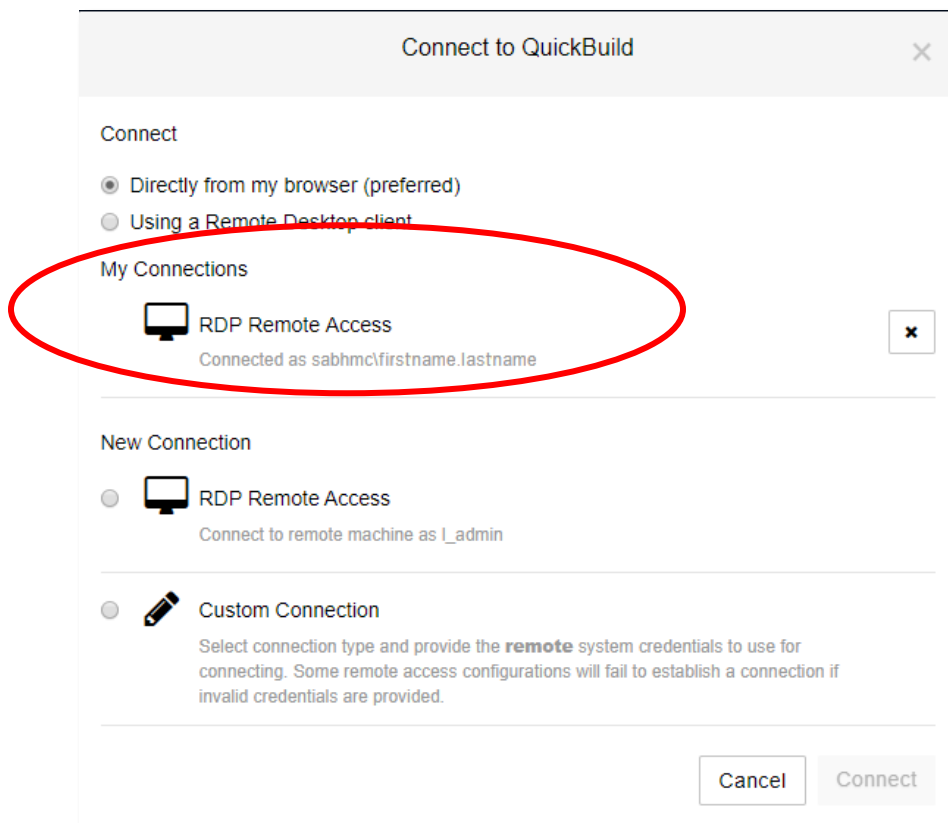

- 1.11. Click this My Connection entry and you will automatically be connected to the remote desktop and your DEC network username will be loaded in the remote desktop's login prompt.
- 1.12. Enter your DEC network password to complete your login.